

Pure Freude
an Wasser

GROHE

WORK SMARTER TOUR 2016

Polska



Piotr Strzalkowski
Warszawa 04.2016

GROHE | MASTERS OF TECHNOLOGY

GROHE TRUCK 2016 OUTDOOR VIEW



GROHE TRUCK 2016: PLAN

REBUILD TOP VIEW

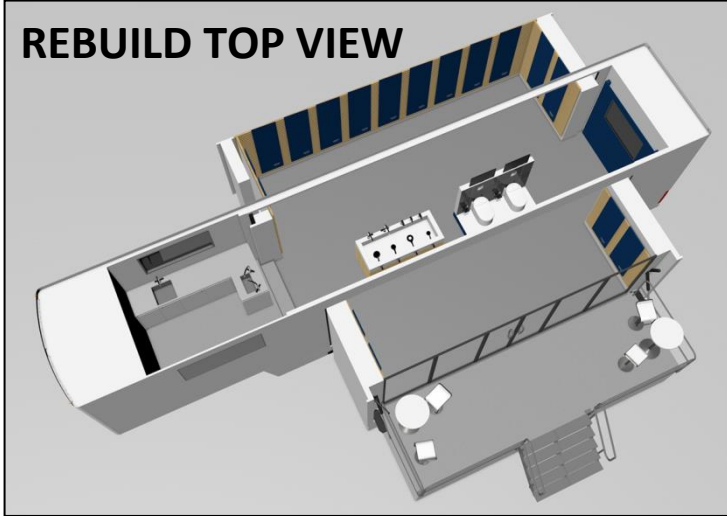

**PROPOSAL ALIGNED
WITH DESIGN DEPARTMENT**



Opening up spaces - Working shower fountain - high quality finishing

GROHE TRUCK 2016

PLAN INSIDE

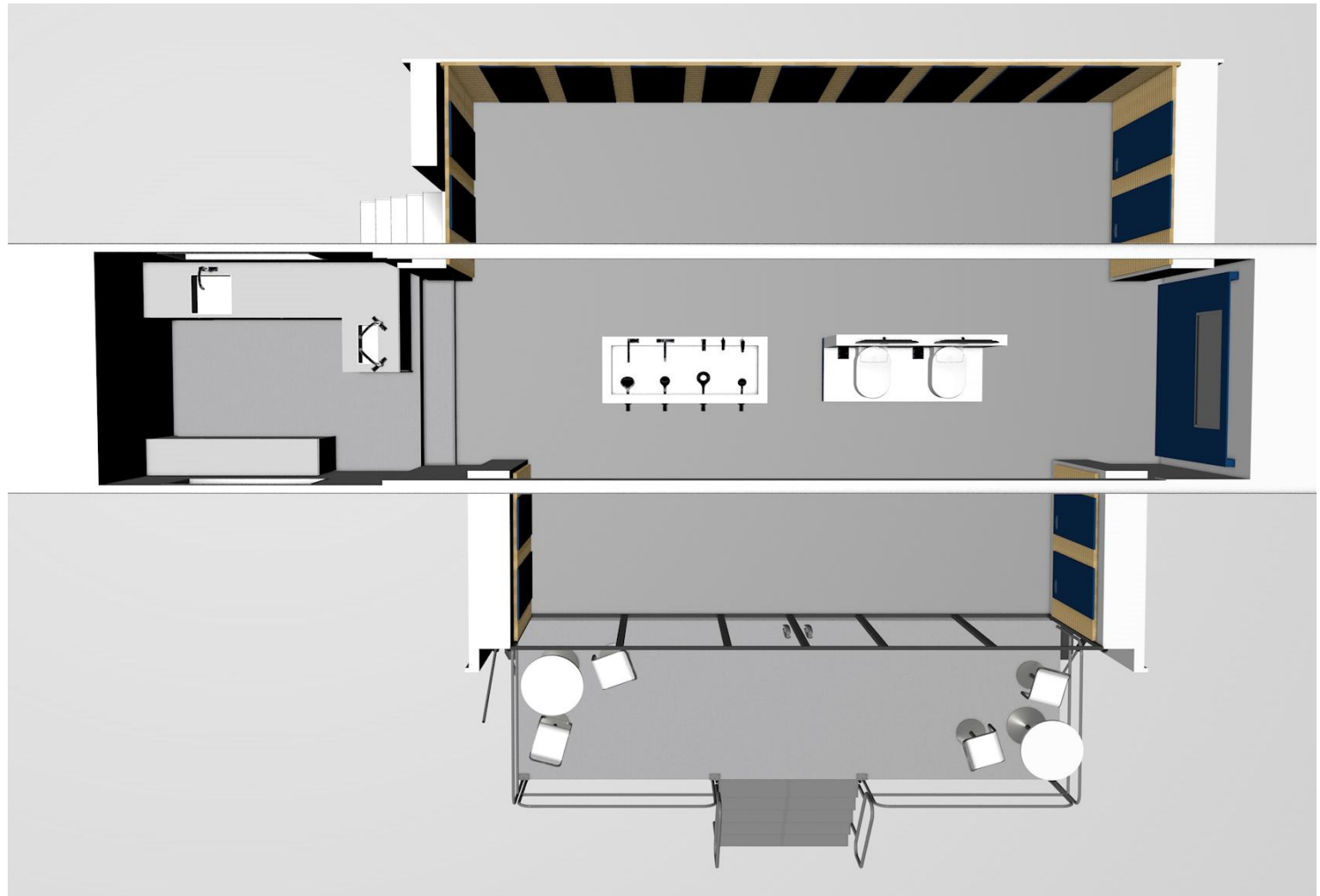

GROHE TRUCK 2016 PLAN



GROHE TRUCK 2016

GENERAL OVERVIEW – RIGHT SIDE



GROHE TRUCK 2016

GENERAL OVERVIEW – LEFT SIDE



GROHE TRUCK 2016

GENERAL OVERVIEW – IN THE MIDDLE



GROHE TRUCK 2016

PRODUCTS ON PANNELS AND SHR TOILETS



GROHE TRUCK 2016

PRODUCTS ON PANNELS



We do have more SKUS on the truck than before, which makes it much more valuable.

GROHE TRUCK 2016 PRODUCTS ON PANNELS



GROHE TRUCK 2016

PRODUCTS ON PANELS, OPERATING PRODUCTS



Working shower fountain - high quality finishing

GROHE TRUCK 2016 KITCHEN



WORK SMARTER TOUR 2016

FAQS



GIANT 4.2

Vehicle 1

FÜ-MS 519
 mobile: 0151-29266023
grohe1@most-mobile.net

Vehicle 2

FÜ-MS 527
 mobile: 0151-29266024
grohe2@most-mobile.net

Weight:	max. 40 t	max. 40 t
Length incl. tractor unit:	16.5 meters	16.5 meters
Length without tractor unit:	13.80 meters	13.73 meters
Width:	2.55 meters	2.55 meters
Height:	ca. 4 – 4.10 meters	ca. 4 – 4.10 meters
Height with railing:	495 cm	
Max. trailer width event mode:	974 cm	
Minimum trailer width event mode:	655 cm	
Total floor space main area:	69.5 m ²	
Thereof raised floor space :	7.00 m ²	
(Thereof veranda space, if available):	10.8 m ²	
Payload with mentioned equipment:	approx. 5,000 kg	

Power supply:

External power supply: 400V / 16A or 32A

Super Silent on-board generator with 32kVA or 25 kW of continuous output

Water supply:

water supply: Gardena and Geka clutch is present

Water tank for fresh and waste water: 80-100 liters

20 m hose for fresh water and 20 m for waste water is on the truck

Axis pressure:

Axis pressure at 4.2. GE: 3 axis with each 9 to

Axis pressure at 4.2. : 2 axis with each 10 to